

NEIGHBORING LAND OWNERS		
REFERENCE #	OWNER	TAX PARCEL ID
1	INTERTRADE HOLDINGS	070-126-016.00
2	BLUE RIDGE MOUNTAIN LANDSCAPING, LLC	070-116-118.00
3	MULTIPLE LAND OWNERS	
4	BF PRESSWOOD & MOZELLE MONTGOMERY	070-116-075.00
5	ROBBIE & REBECCA GEARLEY	070-116-076.00
6	DEBORAH COARSEY	070-116-077.02
7	ROBBIE & REBECCA GEARLEY	070-116-077.01
8	WHITEWATER THREE, LLC	070-127-401.02
9	THEODORE CHAPMAN	070-127-463.00

NOTE: BOUNDARY SURVEY REQUIRED TO IDENTIFY PARCEL BOUNDARIES OF NEIGHBORING LAND OWNERS.

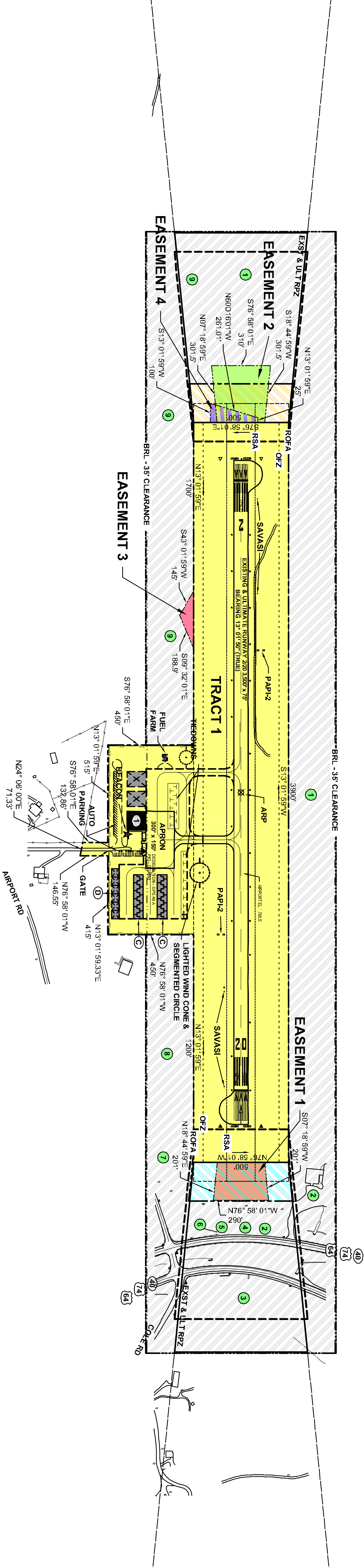

LEGEND		
DESCRIPTION	EXISTING	ULTIMATE
RUNWAY CENTERLINE	—————	—————
RUNWAY SAFETY AREA (RSA)	—————	—————
RUNWAY OBJECT FREE AREA (ROFA)	—————	—————
RUNWAY OBSTACLE FREE ZONE (ROFZ)	—————	—————
RUNWAY PROTECTION ZONE (RPZ)	—————	—————
BUILDING RESTRICTION LINE (BRL)	—————	—————
AIRPORT PAVEMENT	—————	—————
AIRPORT REFERENCE POINT	⊗	⊗
AIRPORT BUILDINGS	—————	—————
OTHER BUILDINGS	—————	—————
AIRPORT PROPERTY LINE	—————	—————
AIRPORT EASEMENT LINES	—————	—————
FENCE	—————	—————
ROADS	—————	—————
TREE LINE	—————	—————
GROUND ELEVATION CONTOURS	—————	—————
ROTATING BEACON	★	★
THRESHOLD LIGHTS	⬢	⬢
REILS	⋈	⋈
GVGSI (EXST SAVASI) (ULT PARZ)	—	—
HOLD LINE	—	—

EXISTING PROPERTY & EASEMENT						
REFERENCE #	DEED BOOK / PAGE	PREVIOUS OWNER	ACREAGE	DATE OF ACQUISITION	GRANT #	PURPOSE OF ACQUISITION OR EASEMENT
TRACT 1	51/383 -385	TENNESSEE CORPORATION	5.8 ACRES	NOVEMBER 19, 1985	-	AIRPORT CONSTRUCTION
EASEMENT 1	51/383 -385	TENNESSEE CORPORATION	1.2 ACRES	NOVEMBER 19, 1985	-	AVIGATION AND TREE CLEARING
EASEMENT 2	51/383 -385	TENNESSEE CORPORATION	1.3 ACRES	NOVEMBER 19, 1985	-	AVIGATION AND TREE CLEARING
EASEMENT 3	51/383 -385	TENNESSEE CORPORATION	0.24 ACRES	NOVEMBER 19, 1985	-	AVIGATION AND TREE CLEARING
EASEMENT 4	51/383 -385	TENNESSEE CORPORATION	0.36 ACRES	NOVEMBER 19, 1985	-	AVIGATION AND TREE CLEARING

PROPOSED PROPERTY & EASEMENT ACQUISITION						
REFERENCE #	DEED BOOK / PAGE	PREVIOUS OWNER	ACREAGE	TYPE	FEE	PURPOSE OF ACQUISITION OR EASEMENT
TRACT 2	-	-	2.5 ACRES	FEE	-	RSA IMPROVEMENTS & ROFA
TRACT 3	-	-	2.5 ACRES	FEE	-	RSA IMPROVEMENTS & ROFA
EASEMENT 5	-	-	79.3 ACRES	EASEMENT	-	RPZ & BRL

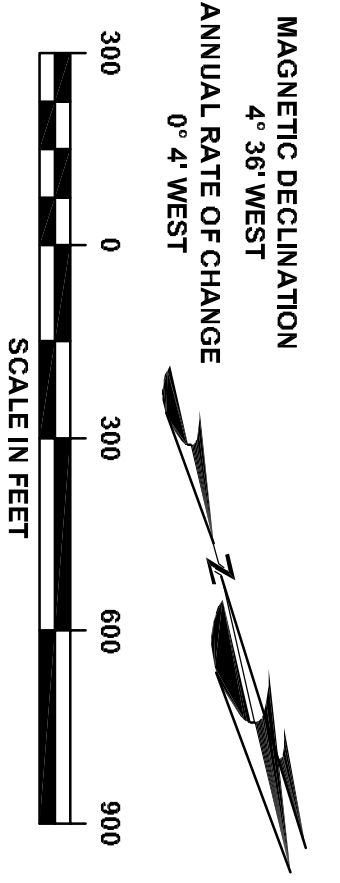

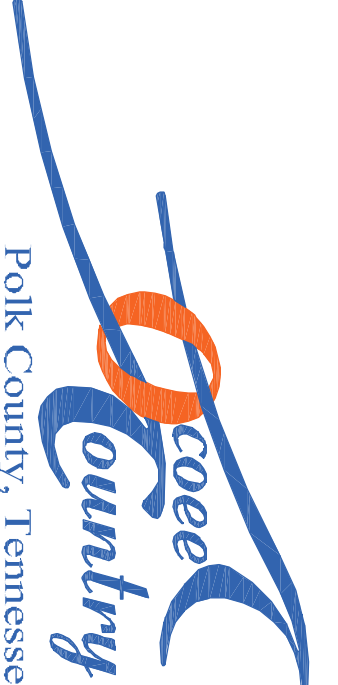

Polk County, Tennessee

MARTIN CAMPBELL FIELD
COPPERHILL, TENNESSEE

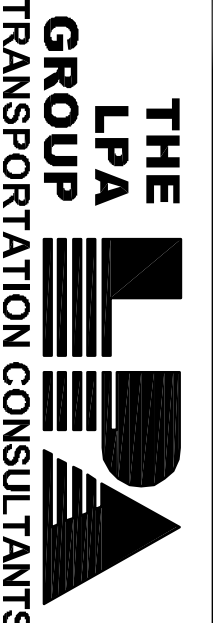

THE LPA GROUP
TRANSPORTATION CONSULTANTS

Columbia, SC • Hendersonville, TN • West Columbia, SC • Greenville, SC
Rock Hill, SC • Charleston, SC • Charlotte, NC • Greenville, NC
Raleigh, NC • Apex, NC • Atlanta, GA • Baton Rouge, LA • Mobile, AL
Little Rock, AR • Knoxville, TN • Tampa, FL • Tallahassee, FL • Orlando, FL
West Palm Beach, FL • Sarasota, FL • Jacksonville, FL

DESIGNER: TGM

TECHNICIAN: TGM

CHECKED BY: JD

PROJECT NUMBER: PL778001

- NOTES**
- COORDINATES SHOWN HEREON ARE IN NAD83.
 - ALL ELEVATIONS ARE BASED ON NAVD88, ABOVE MEAN SEA LEVEL (AMSL).
 - ALL BEARINGS SHOWN HAVE BEEN UPDATED TO TRUE NORTH AND NOT MAGNETIC NORTH.
 - ULTIMATE LAND ACQUISITION SHOULD BE COORDINATED WITH TDOT, AERONAUTICS DIVISION.

REVISIONS		
No.	Description	Date

Project Name: **AIRPORT LAYOUT PLAN UPDATE**

Drawing Name: **AIRPORT PROPERTY MAP**

TDOT Project Number: **70-555-0103-04**

Approved Drawing Reference: **FEBRUARY 2009**

Date: **FEBRUARY 2009**

Division: **PLANNING**

Scale: **1" = 300'**

Drawing Number: **6**